

This drawing contains confidential information and is the property of Standardbox AB, Solvesborg, Sweden. Without whose permission it may not be copied, shown or handed to a third party or otherwise used, and it is to be returned promptly upon request to Standardbox AB.

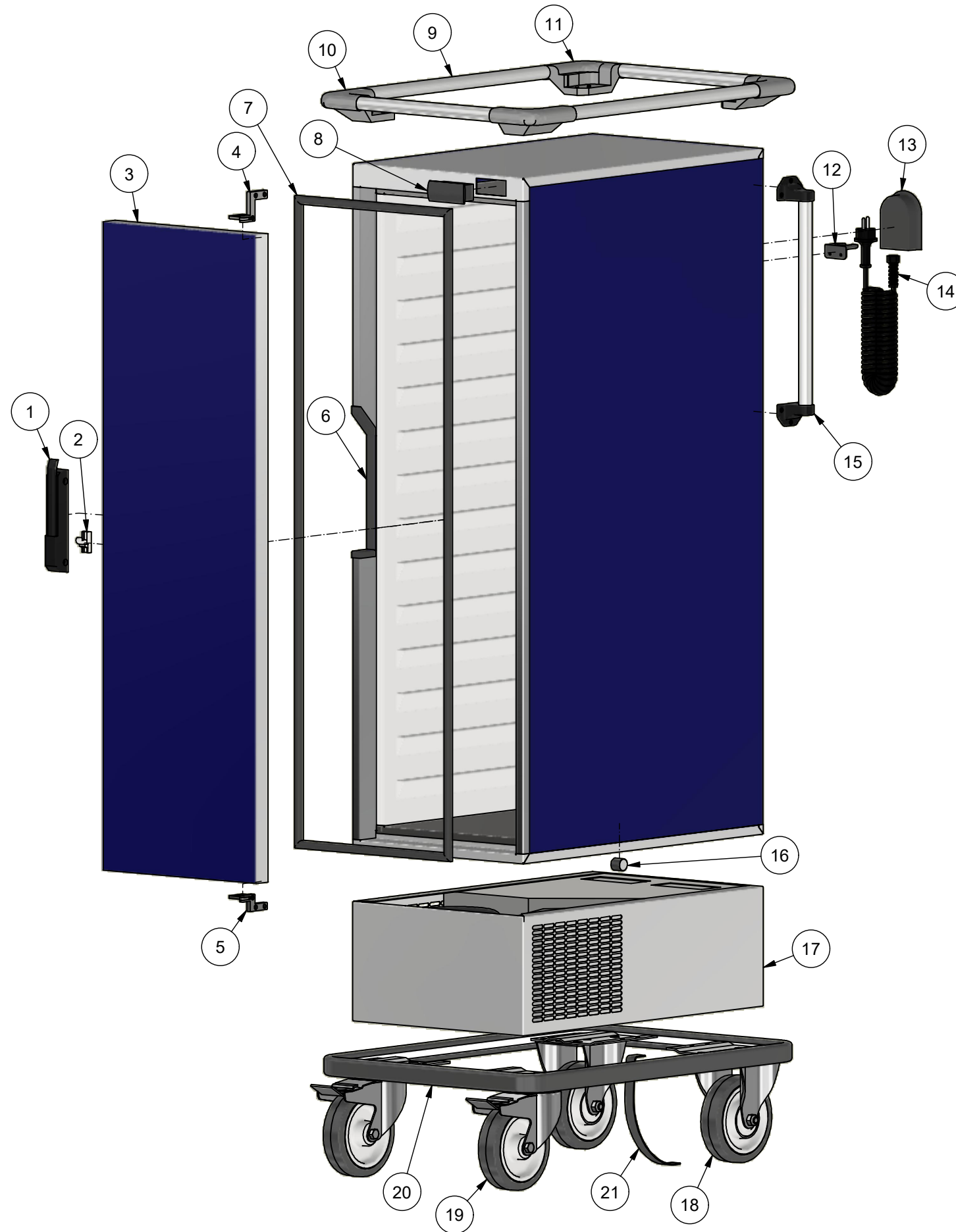

| Nr | Art.no | Benämning | Description |
|----|----------|--------------------------|--------------------------------|
| 1 | 311031 | Engreppshandtag | One grip handle |
| 2 | 311032 | Låshake | Locking hook |
| 3 | 122209-Z | Dörr kpl. K210 | Door complete K210 |
| 4 | 311033 | Övre gångjärn | Upper hinge |
| 5 | 311033 | Nedre gångjärn | Lower hinge |
| 6 | 311022 | Plastbalja till lås | Lock fitting |
| 7 | 313011 | Tätlist K210 | Sealing kit K210 |
| 8 | 312008 | Digital display kall | Digital display cold |
| 9 | 213027-1 | Toppram kpl. K210 | Spacebar uppercomplete K210 |
| 10 | 314061 | Plasthorn vänster | Plastic corner left |
| 11 | 314060 | Plasthorn höger | Plastic corner right |
| 12 | 219035 | Sladdhållare | Cable holder |
| 13 | 314030 | Kopplingshus | Clutch small with lid |
| 14 | 312009 | Spiralsladd | Spiralcord |
| 15 | 212011 | Extra handtag set om 2 | Extra handles set of 2 |
| 16 | 219017 | Magnet | Magnetic door holder |
| 17 | 312303 | Kompressor | Compressor |
| 18 | 318096 | Fast hjul 160mm | Castor firm 160mm |
| 19 | 318095 | Länkhjul 160mm med broms | Castor swivel 160mm with brake |
| 20 | 213043-1 | Vagnsram utan hjul | Trolley frame without castors |
| 21 | 212024 | Jordremsa | Antistatic strip |

A3

Ritad i Inventor

| | | | |
|-----------|----------|---|---------|
| Ordernr. | Radnr. | Färdig | Station |
| Material | Tjocklek | SDX THERMOBOX | |
| Yta | Beh. | K210 (14GN 1/1) | |
| Klippm. | Ant. | Reservdelista Spare parts list | |
| Klippm. | Ant. | | |
| Klippm. | Ant. | | |
| Klippm. | Ant. | | |
| Skala | Rit. | Dat | Tol. |
| | NJ | 2022-04-04 | ± |
| Ritn.Nr. | | | Rev. |
| 122209-ZK | | | 01 |